

assembly instructions

Components: 1 FRONT PANEL (with DOOR), 3 SIDE PANELS, 4 CONNECTOR STRIPS, 2 SHELVES, 1 TOP, 1 LID, 1 PULL-OUT-PANEL, 1 PUSH-PULL-TOOL

START HERE - it's easy
- follow these instructions

NB: Earthmaker components are designed to fit together tightly. But they are made from plastic so do not use excessive force, such as with a hammer or pliers, during assembly. Use a little oil or silicon spray to lubricate any parts that do not easily fit together.

NOTE: Your Earthmaker can be carried to its final site after assembly.

- 1** Stand the **FRONT PANEL** on a flat, level surface (NB: see User Guide - Site Selection). Stand a **SIDE PANEL** at right-angles to the front panel.

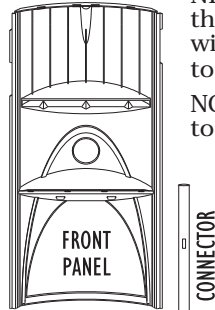

- 2** Pull the corner tabs together so they overlap. Slide the **CONNECTOR STRIP** between the overlapping tabs - pointed end down. Use the handle at the bottom of the connector to guide the tip.

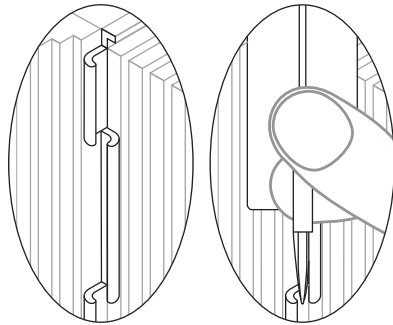

PULL CORNER TABS TOGETHER SO THEY OVERLAP

SLIDE CONNECTOR BETWEEN OVERLAPPING TABS

- 3** Stand another **SIDE PANEL** at right-angles to the other side of the front panel. Repeat step 2.

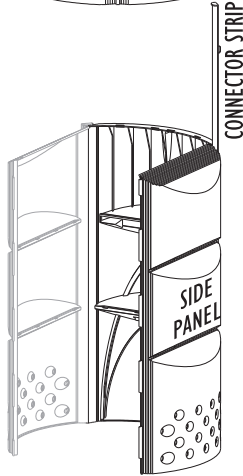
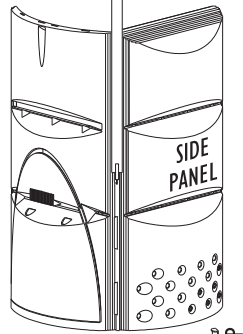

- 4** Fit a **SHELF** to the front and side panels at the lower position. NB: Ensure the shelf lugs are aligned with the slots in the front and side panels. Working across the back of the shelf start here - and then down the sides of the shelf gradually push the lugs into slots.

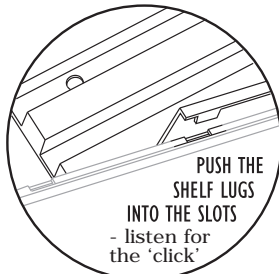
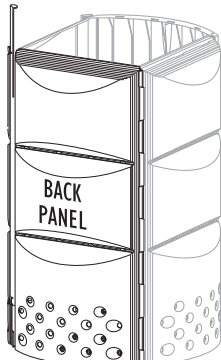
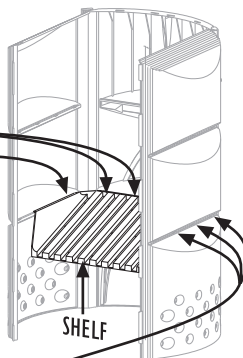

NB: MAKE SURE THE LUGS ARE IN PLACE - check from the outside

PUSH THE SHELF LUGS INTO THE SLOTS - listen for the 'click'

- 5** After the lower shelf is secure place the **BACK PANEL** between the two side panels - pull the tabs together and slide the connector strips between them as in step 2.

- 6** Fit the other **SHELF** to the back panel and the two side panels - pushing the lugs into the slots.

NOTE: This upper shelf slopes down from the back panel towards the front, while the lower shelf slopes down from the front panel towards the back.

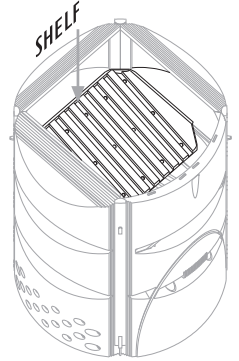

- 7** Fit the **LID** to the **TOP** in the fully open position. Align the lug on the spindle with the notch in the hole. Holding the lid at a 45° angle, push the spindle firmly into place then rotate the lid to the closed position.

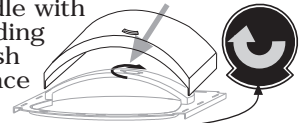

Check from underneath to ensure the spindle is fully in place and rotate lid to the open position.

- 8** Fit the **TOP PANEL**. Starting with the back and sides, snap the slots over the tabs. Support the side panels from the inside while pushing the top panel down to make a definite click. Snap the slots at the front over the tabs on the Front Panel while pushing the front panel out from the inside.

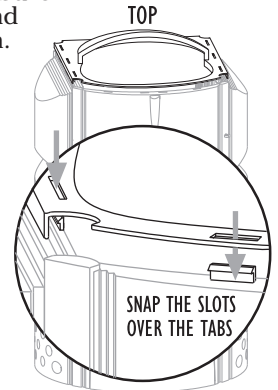

- 9** Insert the **PULL-OUT PANEL** into the slot above the door. Place the **DOOR** in the front panel so that its bottom edge fits behind the rim.

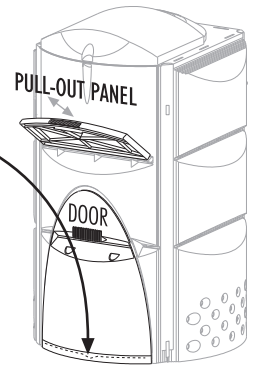

- 10** Position the Earthmaker, so that it is:

- conveniently positioned in relation to your kitchen
- on a flat, level, well drained surface (eg: paving slabs)
- shaded from hot sun
- suitably positioned for extracting mature compost.

CHECK that the top is properly in place after moving.

- 11** Hang the **PUSH-PULL-TOOL** on a hook at the top of one of the connector strips.

Your Earthmaker is now ready for use - read the User Guide.

